

REVISED 02-14 - A STUD HEIGHT OF 4" WAS ADDED TO THE * NOTE.

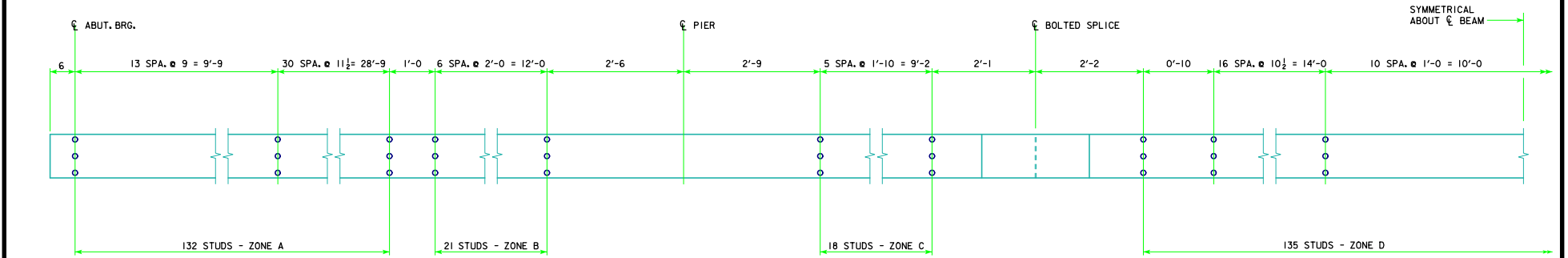

* NOTE: STUD HEIGHTS (3½", 4" OR 5") FOR THE LOCATIONS SHOWN SHALL BE DETERMINED BY THE DESIGNER. ON "MISCELLANEOUS DETAILS 180'-0" BRIDGE" SHEET, STUD HEIGHTS CAN BE IDENTIFIED BY THE DESIGNER IN A TABLE CORRESPONDING TO THE ZONES LISTED ON THIS SHEET.

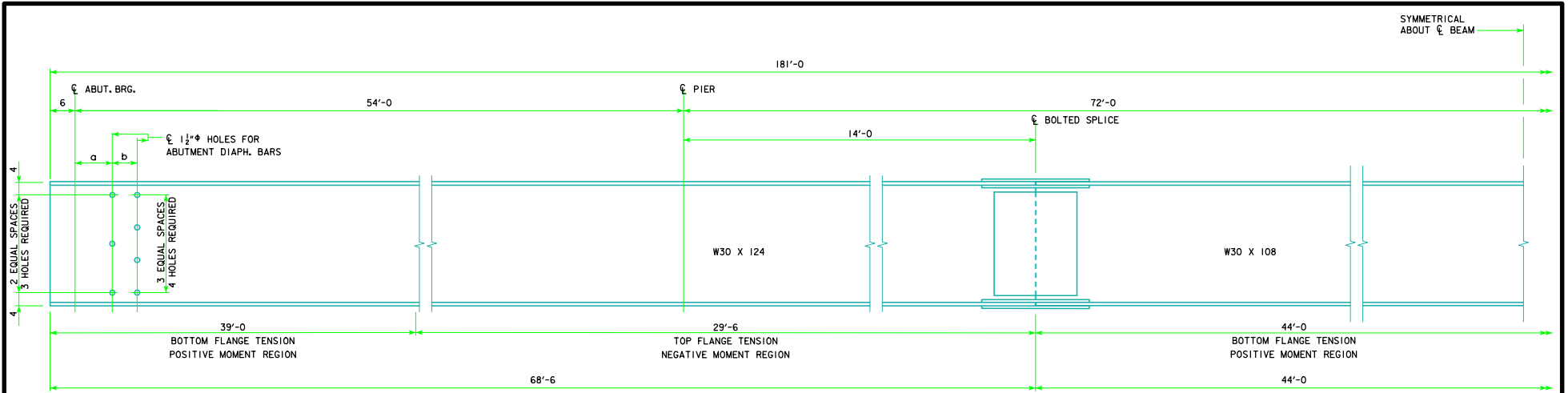
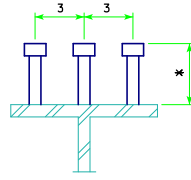

SHEAR STUD DETAILS
NOTE : ALL STUDS TO BE ¾"φ

SKEW	a (IN)	b (IN)
0°	9	6
10°	9½	6½
20°	9¾	6¾
30°	10¾	6¾
45°	12¼	8½

LATEST REVISION DATE
02-14
Norman E. Mc Donald
APPROVED BY BRIDGE ENGINEER

Iowa Department of Transportation
Highway Division

STANDARD DESIGN - 40' ROADWAY, 3 SPAN BRIDGES

ROLLED STEEL BEAM BRIDGES

JUNE, 2010

BEAM PLAN AND ELEVATION
180'-0" BRIDGE

RS40-072-10