

		CAP																							
REINFORCING STEEL		160'-0"		180'-0"		200'-0"		220'-0"		240'-0"		260'-0"		280'-0"		300'-0"		320'-0"		340'-0"					
BAR LENGTH	SHAPE	NO.	SIZE	WEIGHT	NO.	SIZE	WEIGHT	NO.	SIZE	WEIGHT	NO.	SIZE	WEIGHT	NO.	SIZE	WEIGHT	NO.	SIZE	WEIGHT	NO.	SIZE	WEIGHT			
Q1	57'-8"	7	9	1372	7	9	1372	7	9	1372	6	9	1176	6	10	1489	6	10	1489	6	11	1838	6	11	1838
Q2	57'-8"	4	8	616	4	8	616	4	9	784	6	9	1176	6	9	1176	6	10	1489	6	10	1489	6	11	1838
Q3	57'-8"	4	8	616	4	8	616	4	8	616	4	9	784	4	9	784	4	10	993	4	10	993	4	10	993
6o4	57'-8"	6	6	520	6	6	520	6	6	520	6	6	520	6	6	520	6	6	520	6	6	520	6	6	520
6o5	55'-4"	2	6	166	2	6	166	2	6	166	2	6	166	2	6	166	2	6	166	2	6	166	2	6	166
6o6	48'-10"	2	6	147	2	6	147	2	6	147	2	6	147	2	6	147	2	6	147	2	6	147	2	6	147
6o7	42'-3"	2	6	127	2	6	127	2	6	127	2	6	127	2	6	127	2	6	127	2	6	127	2	6	127
6o8	35'-8"	2	6	107	2	6	107	2	6	107	2	6	107	2	6	107	2	6	107	2	6	107	2	6	107
8b1	30'-4"	8	8	648	8	8	648	8	8	648	8	8	648	8	8	648	8	8	648	8	8	648	8	8	648
5c1	VARIES	34	5	668	34	5	668	34	5	668	34	5	674	34	5	674	34	5	674	34	5	674	34	5	674
5c2	VARIES	8	5	155	8	5	155	8	5	155	8	5	156	12	5	235	12	5	235	12	5	235	12	5	235
5c3	VARIES	56	5	866	56	5	866	56	5	866	56	5	876	56	5	876	72	5	1126	72	5	1126	92	5	1439
5c4	7'-5"	28	5	217	28	5	217	28	5	217	28	5	217	28	5	217	28	5	217	28	5	217	28	5	217
① TOTAL (LB.)		6225		6225		6393		6774		7166		7729		8287		8949		8949		9445					
STRUCTURAL CONCRETE (CY)		42.2		42.2		42.2		42.2		42.2		42.2		42.2		42.2		42.2		42.2					

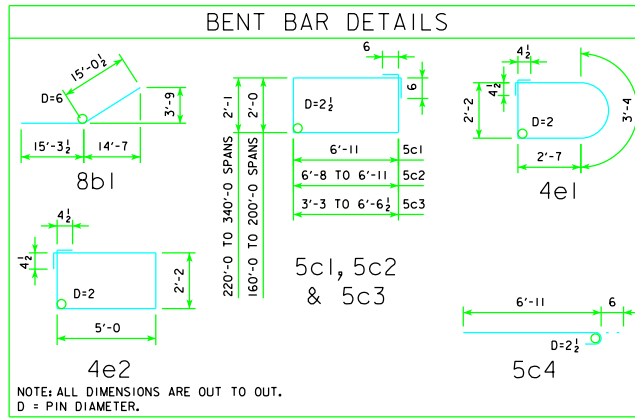

		COLUMN																							
REINFORCING STEEL		160'-0"		180'-0"		200'-0"		220'-0"		240'-0"		260'-0"		280'-0"		300'-0"		320'-0"		340'-0"					
H IN FEET	COLUMN HEIGHT	NO.	SIZE	LENGTH	WEIGHT	NO.	SIZE	LENGTH	WEIGHT	NO.	SIZE	LENGTH	WEIGHT	NO.	SIZE	LENGTH	WEIGHT	NO.	SIZE	LENGTH	WEIGHT	NO.	SIZE	LENGTH	WEIGHT
16	4'-9"	12.1	74	9	7'-6"	1887	10	4	11'-5"	76	35	4	15'-1"	353	2316										
17	5'-9"	14.6	74	9	8'-6"	2139	12	4	11'-5"	92	42	4	15'-1"	423	2654										
18	6'-9"	17.2	74	9	9'-6"	2390	14	4	11'-5"	107	49	4	15'-1"	494	2991										
19	7'-9"	19.7	74	9	10'-6"	2642	16	4	11'-5"	122	56	4	15'-1"	564	3328										
20	8'-9"	22.3	74	9	11'-6"	2893	18	4	11'-5"	137	63	4	15'-1"	635	3665										
21	9'-9"	24.8	74	9	12'-6"	3145	20	4	11'-5"	153	70	4	15'-1"	705	4003										
22	10'-9"	27.3	74	9	13'-6"	3397	22	4	11'-5"	168	77	4	15'-1"	776	4341										
23	11'-9"	29.9	74	9	14'-6"	3648	24	4	11'-5"	183	84	4	15'-1"	846	4677										
24	12'-9"	32.4	74	9	15'-6"	3900	26	4	11'-5"	198	91	4	15'-1"	917	5015										
25	13'-9"	35.0	74	9	16'-6"	4151	28	4	11'-5"	214	98	4	15'-1"	987	5352										
26	14'-9"	37.5	74	9	17'-6"	4403	30	4	11'-5"	229	105	4	15'-1"	1058	5690										
27	15'-9"	40.1	74	9	18'-6"	4655	32	4	11'-5"	244	112	4	15'-1"	1128	6027										
28	16'-9"	42.6	74	9	19'-6"	4906	34	4	11'-5"	259	119	4	15'-1"	1199	6364										
29	17'-9"	45.1	74	9	20'-6"	5158	36	4	11'-5"	275	126	4	15'-1"	1270	6703										
30	18'-9"	47.7	74	9	21'-6"	5409	38	4	11'-5"	290	133	4	15'-1"	1340	7039										
31	19'-9"	50.2	74	9	22'-6"	5661	40	4	11'-5"	305	140	4	15'-1"	1411	7377										
32	20'-9"	52.8	74	9	23'-6"	5913	42	4	11'-5"	320	147	4	15'-1"	1481	7714										
33	21'-9"	55.3	74	9	24'-6"	6164	44	4	11'-5"	336	154	4	15'-1"	1552	8052										
34	22'-9"	57.9	74	9	25'-6"	6416	46	4	11'-5"	351	161	4	15'-1"	1622	8389										
35	23'-9"	60.4	74	9	26'-6"	6667	48	4	11'-5"	366	168	4	15'-1"	1693	8726										
36	24'-9"	62.9	74	9	27'-6"	6919	50	4	11'-5"	381	175	4	15'-1"	1763	9063										
37	25'-9"	65.5	74	9	28'-6"	7171	52	4	11'-5"	397	182	4	15'-1"	1834	9402										
38	26'-9"	68.0	74	9	29'-6"	7422	54	4	11'-5"	412	189	4	15'-1"	1904	9738										
39	27'-9"	70.6	74	9	30'-6"	7674	56	4	11'-5"	427	196	4	15'-1"	1975	10,076										
40	28'-9"	73.1	74	9	31'-6"	7925	58	4	11'-5"	442	203	4	15'-1"	2045	10,412										

PIER NOTES:

SEE "TEE PIER NOTES" ON RS40-003-10 FOR NOTES REGARDING APPLICATION OF THESE PIER STANDARDS.

MINIMUM CLEAR DISTANCE FROM FACE OF CONCRETE TO NEAR REINFORCING BAR SHALL BE 2 INCHES UNLESS OTHERWISE NOTED OR SHOWN.

① SEE SHEET RS40-169-10 FOR STEP REINFORCING STEEL QUANTITIES AND DETAILS.

LATEST REVISION DATE <i>Thomas L. Mc Donald</i> APPROVED BY BRIDGE ENGINEER	
	STANDARD DESIGN - 40' ROADWAY, 3 SPAN BRIDGES ROLLED STEEL BEAM BRIDGES JUNE, 2010
	TEE PIER CAP & COLUMN DETAILS 45° SKEW

RS40-157-10