

		CAP																											
REINFORCING STEEL		160'-0		180'-0		200'-0		220'-0		240'-0		260'-0		280'-0		300'-0		320'-0		340'-0									
BAR	LENGTH	SHAPE	NO.	SIZE	WEIGHT	NO.	SIZE	WEIGHT	NO.	SIZE	WEIGHT	NO.	SIZE	WEIGHT	NO.	SIZE	WEIGHT	NO.	SIZE	WEIGHT	NO.	SIZE	WEIGHT						
a1	47'-2		6	9	962	6	9	962	6	10	1218	6	10	1218	6	11	1504	6	11	1504	6	11	1504	6	11	1504			
a2	47'-2		6	8	756	6	9	962	6	9	962	6	10	1218	6	10	1218	6	11	1504	6	11	1504	6	11	1504	6	11	1504
a3	47'-2		--	--	--	--	--	--	--	--	--	--	--	--	--	--	--	4	6	283	4	7	386	4	9	641			
6a4	47'-2		6	6	425	6	6	425	6	6	425	6	6	425	6	6	425	6	6	425	6	6	425	6	6	425	6	6	425
6a5	45'-0		2	6	135	2	6	135	2	6	135	2	6	135	2	6	135	2	6	135	2	6	135	2	6	135	2	6	135
6a6	38'-3		2	6	115	2	6	115	2	6	115	2	6	115	2	6	115	2	6	115	2	6	115	2	6	115	2	6	115
6a7	31'-6		2	6	95	2	6	95	2	6	95	2	6	95	2	6	95	2	6	95	2	6	95	2	6	95	2	6	95
8b1	25'-1		8	8	536	8	8	536	8	8	536	8	8	536	8	8	536	8	8	536	8	8	536	8	8	536	8	8	536
5c1	17'-7		28	5	514	28	5	514	28	5	514	28	5	514	28	5	514	28	5	514	28	5	514	28	5	514	28	5	514
5c2	VARIES		8	5	145	8	5	145	8	5	145	8	5	145	12	5	217	12	5	217	12	5	217	12	5	217	12	5	217
5c3	VARIES		44	5	642	44	5	642	44	5	642	44	5	642	44	5	642	44	5	642	56	5	818	56	5	818	72	5	1051
5c4	6'-11		22	5	159	22	5	159	22	5	159	22	5	159	22	5	159	22	5	159	22	5	159	22	5	159	22	5	159
① TOTAL (LB.)			4484		4690		4946		4946		5274		5736		6022		6538		6641		6896								
STRUCTURAL CONCRETE (CY)			32.5		32.5		32.5		32.5		32.5		32.5		32.5		32.5		32.5		32.5								

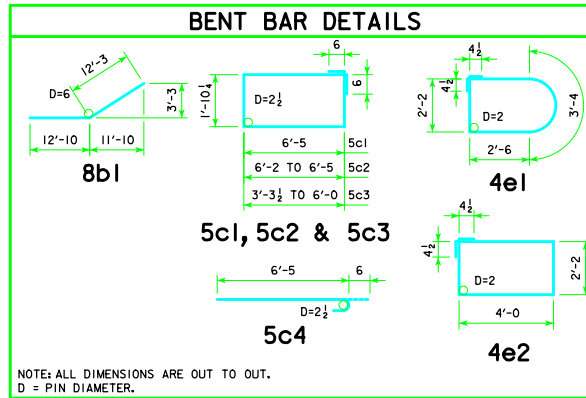

NOTE: ALL DIMENSIONS ARE OUT TO OUT.
D = PIN DIAMETER.

NOTE: THE REINFORCING STEEL QUANTITY IS TO BE INCLUDED ON THE SUMMARY QUANTITIES SHEET IN THE PLAN.

NOTE: THE CONCRETE QUANTITY IS TO BE INCLUDED ON THE SUMMARY QUANTITIES SHEET IN THE PLAN.

NOTE: THE PILE TYPE IS TO BE INCLUDED ON THE SUMMARY QUANTITIES SHEET IN THE PLAN.

		COLUMN															
REINFORCING STEEL		STRUCTURAL CONCRETE (CY)		4e1 BAR		4e2 BAR		TOTAL WEIGHT (LB.)									
H IN FEET	COLUMN HEIGHT	NO.	SIZE	LENGTH	WEIGHT	NO.	SIZE	LENGTH	WEIGHT	NO.	SIZE	LENGTH	WEIGHT	NO.	SIZE	LENGTH	WEIGHT
16	5'-3	10.9	64	9	8'-0	1741	12	4	11'-3	90	42	4	13'-1	367	2198		
17	6'-3	13.0	64	9	9'-0	1958	14	4	11'-3	105	49	4	13'-1	428	2491		
18	7'-3	15.1	64	9	10'-0	2176	16	4	11'-3	120	56	4	13'-1	489	2785		
19	8'-3	17.2	64	9	11'-0	2394	18	4	11'-3	135	63	4	13'-1	551	3080		
20	9'-3	19.2	64	9	12'-0	2611	20	4	11'-3	150	70	4	13'-1	612	3373		
21	10'-3	21.3	64	9	13'-0	2829	22	4	11'-3	165	77	4	13'-1	673	3667		
22	11'-3	23.4	64	9	14'-0	3046	24	4	11'-3	180	84	4	13'-1	734	3960		
23	12'-3	25.5	64	9	15'-0	3264	26	4	11'-3	195	91	4	13'-1	795	4254		
24	13'-3	27.6	64	9	16'-0	3482	28	4	11'-3	210	98	4	13'-1	856	4548		
25	14'-3	29.6	64	9	17'-0	3699	30	4	11'-3	225	105	4	13'-1	918	4842		
26	15'-3	31.7	64	9	18'-0	3917	32	4	11'-3	240	112	4	13'-1	979	5136		
27	16'-3	33.8	64	9	19'-0	4134	34	4	11'-3	255	119	4	13'-1	1040	5430		
28	17'-3	35.9	64	9	20'-0	4352	36	4	11'-3	271	126	4	13'-1	1101	5724		
29	18'-3	38.0	64	9	21'-0	4570	38	4	11'-3	286	133	4	13'-1	1162	6018		
30	19'-3	40.0	64	9	22'-0	4787	40	4	11'-3	301	140	4	13'-1	1224	6312		
31	20'-3	42.1	64	9	23'-0	5005	42	4	11'-3	316	147	4	13'-1	1285	6606		
32	21'-3	44.2	64	9	24'-0	5222	44	4	11'-3	331	154	4	13'-1	1346	6899		
33	22'-3	46.3	64	9	25'-0	5440	46	4	11'-3	346	161	4	13'-1	1407	7193		
34	23'-3	48.4	64	9	26'-0	5658	48	4	11'-3	361	168	4	13'-1	1468	7487		
35	24'-3	50.4	64	9	27'-0	5875	50	4	11'-3	376	175	4	13'-1	1529	7780		
36	25'-3	52.5	64	9	28'-0	6093	52	4	11'-3	391	182	4	13'-1	1591	8075		
37	26'-3	54.6	64	9	29'-0	6310	54	4	11'-3	406	189	4	13'-1	1652	8368		
38	27'-3	56.7	64	9	30'-0	6528	56	4	11'-3	421	196	4	13'-1	1713	8662		
39	28'-3	58.8	64	9	31'-0	6746	58	4	11'-3	436	203	4	13'-1	1774	8956		
40	29'-3	60.8	64	9	32'-0	6963	60	4	11'-3	451	210	4	13'-1	1835	9249		

PIER NOTES:

SEE "TEE PIER NOTES" ON RS40-003-14 FOR NOTES REGARDING APPLICATION OF THESE PIER STANDARDS.

MINIMUM CLEAR DISTANCE FROM FACE OF CONCRETE TO NEAR REINFORCING BAR SHALL BE 2 INCHES UNLESS OTHERWISE NOTED OR SHOWN.

① SEE SHEET RS40-168-14 FOR STEP REINFORCING STEEL QUANTITIES AND DETAILS.

LATEST REVISION DATE	APPROVED BY BRIDGE ENGINEER <i>Norman E. Mc Donald</i>	IOWA DOT Highway Division	
		STANDARD DESIGN - 40' ROADWAY, 3 SPAN BRIDGES	
		ROLLED STEEL BEAM BRIDGES	
		OCTOBER, 2014	
		TEE PIER CAP & COLUMN DETAILS 30° SKEW	RS40-147-10