

REVISED 02-2017 - ADDED 8 SHEAR STUDS AT "CENTERLINE OF BOLTED SPLICE" LOCATION BETWEEN "ZONE C & D". ADDED "SHEAR STUD ON SPLICE PLATE DETAILS" SHOWING 2 STUDS PER ROW. CHANGED NOTE STATING "MISCELLANEOUS DETAILS 300'-0 BRIDGE" (WAS 160'-0 IN ERROR).

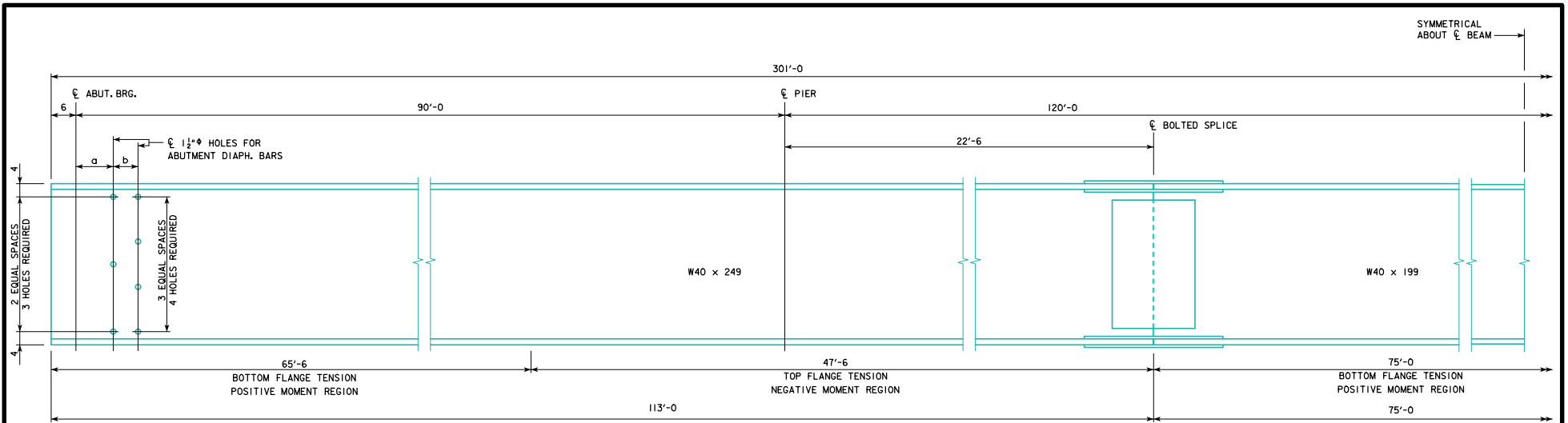

**BEAM ELEVATION**

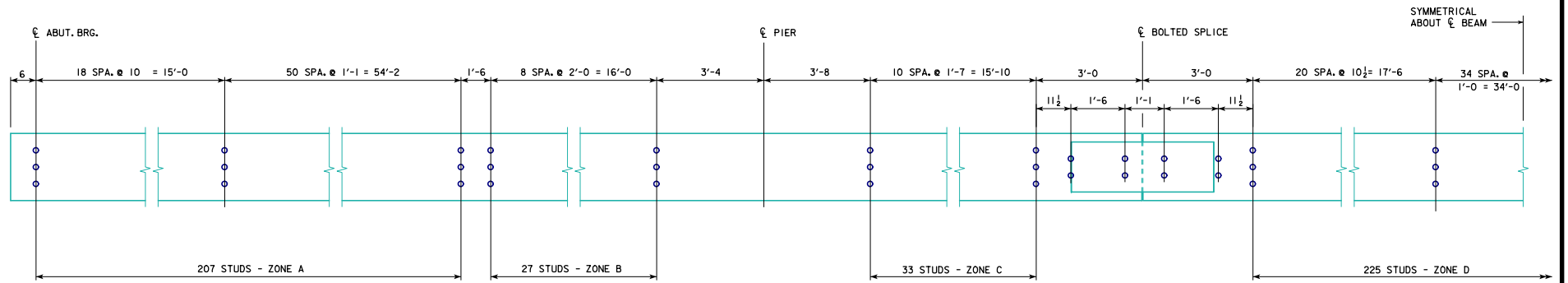

**SHEAR STUD SPACING**

\* NOTE: STUD HEIGHTS (3 1/2\", 4\" OR 5\") FOR THE LOCATIONS SHOWN SHALL BE DETERMINED BY THE DESIGNER. ON "MISCELLANEOUS DETAILS 300'-0 BRIDGE" SHEET, STUD HEIGHTS CAN BE IDENTIFIED BY THE DESIGNER IN A TABLE CORRESPONDING TO THE ZONES LISTED ON THIS SHEET.

STRUCTURAL STEEL	
Δ BEAM WEIGHT	
	71,199 LBS.

Δ WEIGHT OF SHEAR STUDS ARE NOT INCLUDED, SEE MISC. DETAILS - STANDARDS 5252 TO 5261.

NOTE: STRUCTURAL STEEL WEIGHT IS INCLUDED ON THE SUMMARY QUANTITIES SHEET.

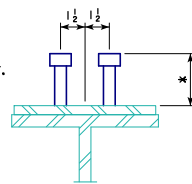

**SHEAR STUD ON SPLICE PLATE DETAILS**  
NOTE: ALL STUDS TO BE 3/4\"/>

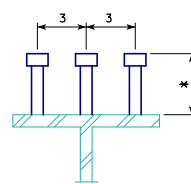

**SHEAR STUD DETAILS**  
NOTE: ALL STUDS TO BE 3/4\"/>

SKEW	a (IN)	b (IN)
0°	9	6
10°	9 1/8	6 1/8
20°	9 3/8	6 3/8
30°	10 1/8	6 7/8
45°	12 1/2	8 1/2

LATEST REVISION DATE  
02-2017  
*Thomas E. McQuinn*  
APPROVED BY BRIDGE ENGINEER

**IOWADOT** Highway Division

STANDARD DESIGN - 40' ROADWAY, 3 SPAN BRIDGES  
**ROLLED STEEL BEAM BRIDGES**

OCTOBER, 2014

**BEAM PLAN AND ELEVATION  
300'-0 BRIDGE**

**RS40-078-14**