

REVISION 03-2019: MODIFIED CHORD SCHEDULE TO ADDRESS MATERIAL AVAILABILITY ISSUES. REPLACED NOTE IDENTIFIER ASTERISKS WITH ENCIRCLED NUMBERS TO IMPROVE READABILITY.  
 -REVISION 04-2019: CHANGED DESIGNATION OF ENCIRCLED NOTE 2 TO ENCIRCLED NOTE 3 TO PERMIT INSERTION OF NEW ENCIRCLED NOTE 2 THAT ALLOWS  
 -REVISION 12-2021: CHANGED DESIGNATION OF ENCIRCLED NOTE 2 TO ENCIRCLED NOTE 3 TO PERMIT INSERTION OF NEW ENCIRCLED NOTE 2 THAT ALLOWS  
 -SUBSTITUTION OF HSS 6.625 x 0.562 FOR HSS 6.625 x 0.500 FOR TRUSS LENGTHS FROM 39'-6 TO 40'-0.  
 -STEELCANTILEVERSIGNTRUSS.dgn - SCST-02-17 - THIS SHEET ISSUED 07-2017.

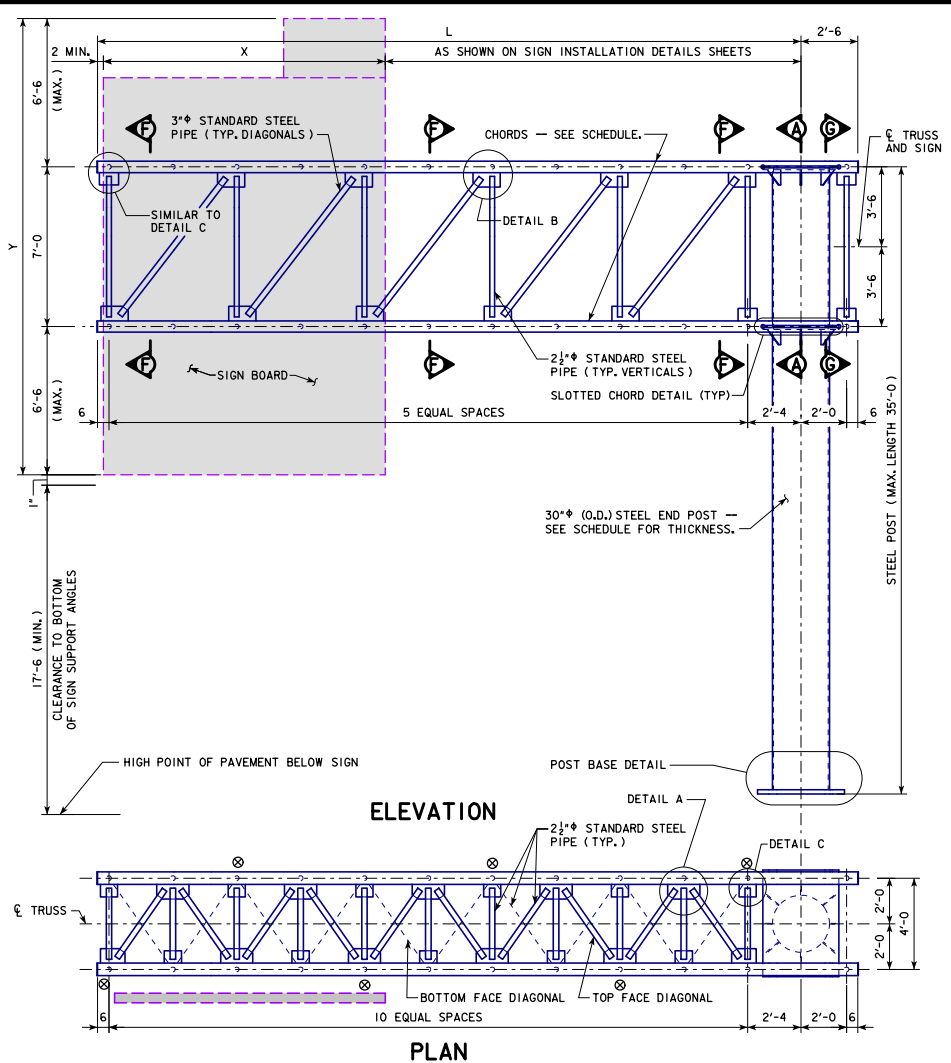

⊗ INDICATES THE CONNECTION OF INTERIOR DIAGONALS IN VERTICAL PLANE TO THE TOP CHORD MEMBERS. SEE SECTION F-F.

TRUSS LENGTH MAX. L	MAX. SIGN HEIGHT Y	MAX. SIGN AREA X*Y FT <sup>2</sup>	CHORDS	POST WALL THICKNESS	CAMBER C
40'-0 (1)	20'-0	400	HSS 6.625 x 0.500 (2)	0.625"	4"
38'-0	20'-0	400	HSS 6.625 x 0.432	0.625"	3 1/2"
36'-0	20'-0	400	HSS 6.625 x 0.432	0.625"	3"
34'-0	20'-0	400	HSS 6.625 x 0.375 (3)	0.625"	2 1/2"
32'-0	20'-0	400	HSS 6.625 x 0.375 (3)	0.625"	2 1/2"
30'-0	20'-0	400	HSS 6.625 x 0.375 (3)	0.625"	2"

- (1) ALTHOUGH THESE STANDARDS ALLOW FOR A TRUSS MAXIMUM CANTILEVER LENGTH OF 40'-0, THE DESIGNER SHOULD CHECK MATERIAL AVAILABILITY BEFORE SELECTING A TRUSS LENGTH GREATER THAN 39'-6. HSS 6.625 CHORDS ARE TYPICALLY STOCKED IN 42'-0 LENGTHS. A TRUSS LENGTH OF 40'-0 REQUIRES A TOTAL CHORD LENGTH OF 42'-6.
- (2) HSS 6.625 x 0.562 MAY BE SUBSTITUTED FOR HSS 6.625 x 0.500 FOR TRUSS LENGTHS FROM 39'-6 TO 40'-0.
- (3) HSS 6.625 x 0.432 MAY BE SUBSTITUTED FOR HSS 6.625 x 0.375 FOR TRUSS LENGTHS FROM 30'-0 TO 36'-0.

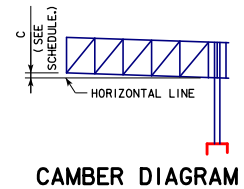

CAMBER DIAGRAM

SEE STANDARD SHEET SCST-04-17 FOR SECTION A-A.  
 SEE STANDARD SHEET SCST-05-17 FOR DETAILS A, B AND C; SECTIONS F-F AND G-G; AND SLOTTED CHORD DETAIL.  
 SEE STANDARD SHEET SCST-06-17 FOR POST BASE DETAIL.

12-2021 LATEST REVISION DATE  APPROVED BY BRIDGE ENGINEER	 STANDARD DESIGN	
	<b>STEEL CANTILEVER SIGN TRUSS</b> JULY, 2017	
	SIGN SUPPORT VIEWS	SCST-02-17