

REVISED 02-14 - A STUD HEIGHT OF 4" WAS ADDED TO THE * NOTE.

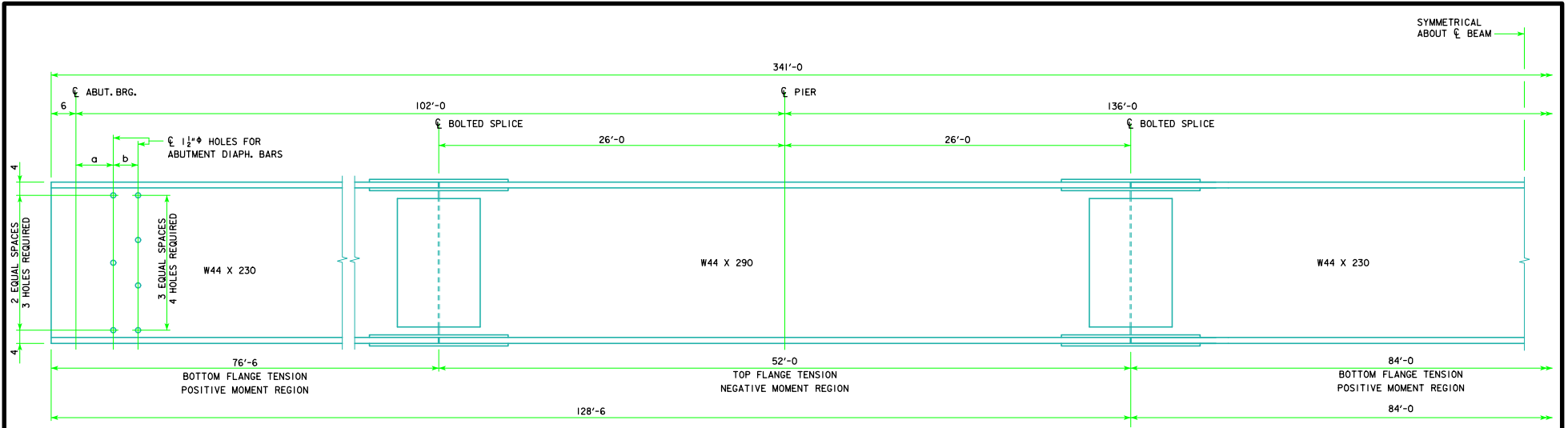

BEAM ELEVATION

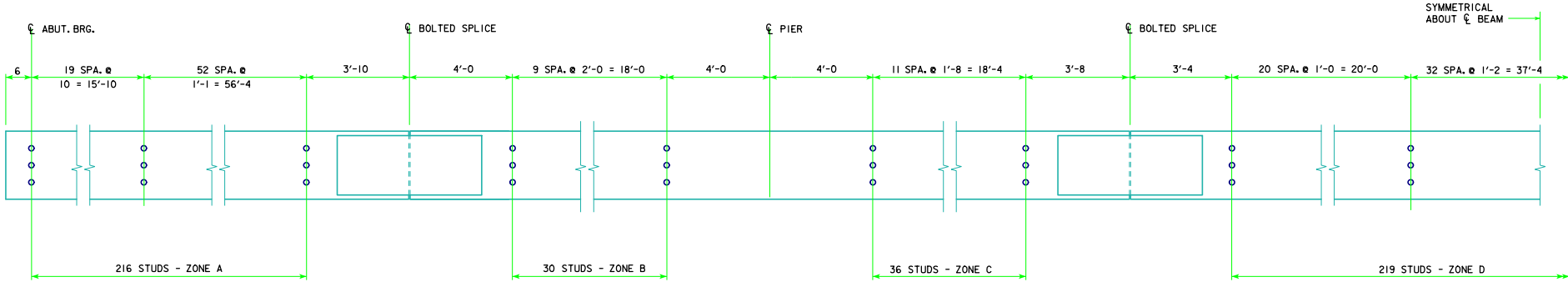

SHEAR STUD SPACING

* NOTE: STUD HEIGHTS (3½", 4" OR 5") FOR THE LOCATIONS SHOWN SHALL BE DETERMINED BY THE DESIGNER. ON "MISCELLANEOUS DETAILS 340'-0 BRIDGE" SHEET, STUD HEIGHTS CAN BE IDENTIFIED BY THE DESIGNER IN A TABLE CORRESPONDING TO THE ZONES LISTED ON THIS SHEET.

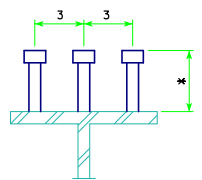

SHEAR STUD DETAILS
NOTE: ALL STUDS TO BE ½"Ø

SKIEW	a (IN)	b (IN)
0°	9	6
10°	9½	6½
20°	9¾	6¾
30°	10¾	6¾
45°	12¾	8½

LATEST REVISION DATE
02-14
Norman E. Mc Donald
APPROVED BY BRIDGE ENGINEER

Iowa Department of Transportation
Highway Division

STANDARD DESIGN - 40' ROADWAY, 3 SPAN BRIDGES
ROLLED STEEL BEAM BRIDGES
JUNE, 2010

BEAM PLAN AND ELEVATION
340'-0 BRIDGE

RS40-080-10