

REVISED 02-14 - A STUD HEIGHT OF 4" WAS ADDED TO THE * NOTE.

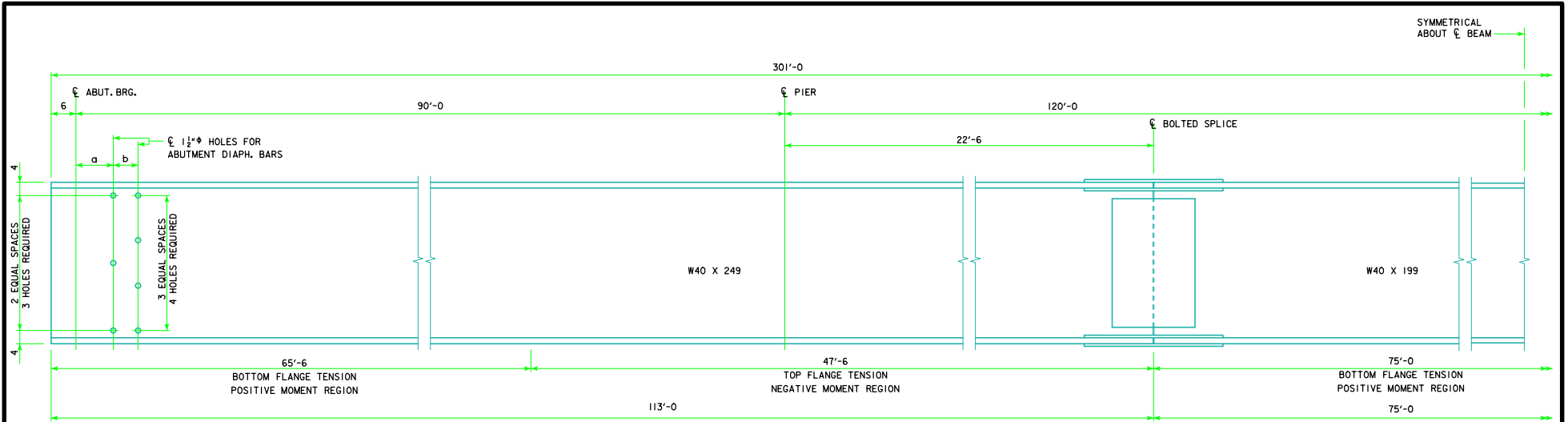

BEAM ELEVATION

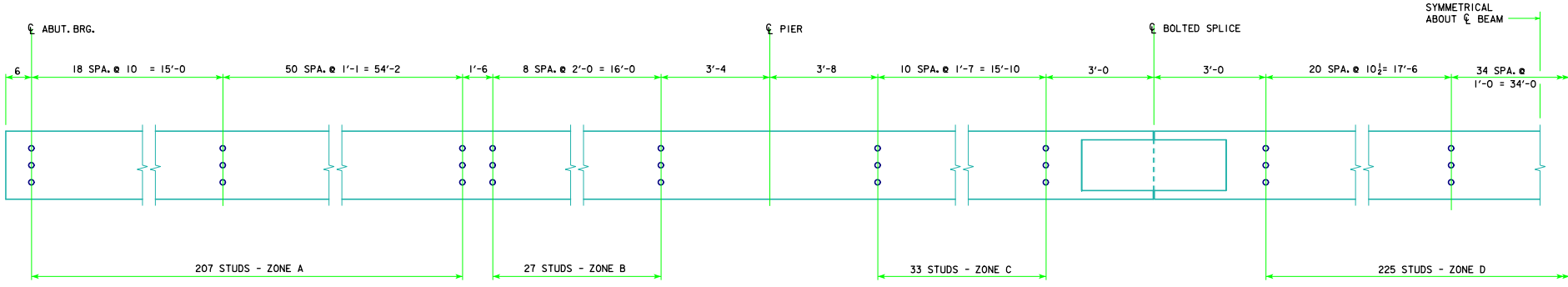

SHEAR STUD SPACING

* NOTE: STUD HEIGHTS (3 1/2", 4" OR 5") FOR THE LOCATIONS SHOWN SHALL BE DETERMINED BY THE DESIGNER. ON "MISCELLANEOUS DETAILS 300'-0 BRIDGE" SHEET, STUD HEIGHTS CAN BE IDENTIFIED BY THE DESIGNER IN A TABLE CORRESPONDING TO THE ZONES LISTED ON THIS SHEET.

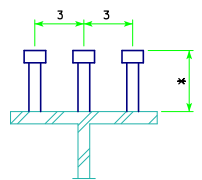

SHEAR STUD DETAILS
NOTE: ALL STUDS TO BE 3/8" DIA

SKEW	a (IN)	b (IN)
0°	9	6
10°	9 1/8	6 1/8
20°	9 3/8	6 3/8
30°	10 1/8	6 7/8
45°	12 1/2	8 1/2

LATEST REVISION DATE: 02-14
APPROVED BY BRIDGE ENGINEER: *Norman E. Mc Donald*

Iowa Department of Transportation
Highway Division
STANDARD DESIGN - 40' ROADWAY, 3 SPAN BRIDGES
ROLLED STEEL BEAM BRIDGES
JUNE, 2010

BEAM PLAN AND ELEVATION
300'-0 BRIDGE
RS40-078-10