

REINFORCING BAR LIST

ONE SUPERSTRUCTURE AND TWO ABUTMENTS

BAR	LOCATION	SHAPE	138'-10"			151'-4"			163'-10"			176'-4"			188'-10"			201'-4"			213'-10"			226'-4"			243'-0"		
			NO.	LENGTH	WEIGHT	NO.	LENGTH	WEIGHT	NO.	LENGTH	WEIGHT	NO.	LENGTH	WEIGHT	NO.	LENGTH	WEIGHT	NO.	LENGTH	WEIGHT	NO.	LENGTH	WEIGHT	NO.	LENGTH	WEIGHT	NO.	LENGTH	WEIGHT
6a1	SLAB TRANSV. TOP & BOT.		339	46'-10"	23,847	369	46'-10"	25,957	399	46'-10"	28,067	429	46'-10"	30,177	459	46'-10"	32,288	489	46'-10"	34,398	519	46'-10"	36,508	549	46'-10"	38,619	589	46'-10"	41,432
5b1	SLAB LONGITUDINAL, TOP & BOT.		212	40'-0"	8,845	212	40'-0"	8,845	318	40'-0"	13,267	318	40'-0"	13,267	318	40'-0"	13,267	424	40'-0"	17,689	424	40'-0"	17,689	424	40'-0"	17,689	530	40'-0"	22,112
5b2	SLAB LONGITUDINAL, TOP & BOT., ENDS		212	33'-9"	7,463	212	40'-0"	8,845	212	27'-3"	6,025	212	33'-6"	7,407	212	39'-9"	8,789	212	27'-0"	5,970	212	33'-3"	7,352	212	39'-6"	8,734	212	28'-10"	6,376
6b3	SLAB LONGITUDINAL, TOP @ PIERS		98	12'-10"	1,889	98	13'-10"	2,036						98	15'-10"	3,172	98	17'-0"	3,405	98	18'-0"	3,606							
7b3	SLAB LONGITUDINAL, TOP @ PIERS																												
8b3	SLAB LONGITUDINAL, TOP @ PIERS																												
5d1	PIER DIAPH. ENDS		12	3'-6"	44	12	3'-6"	44	12	3'-6"	44	12	3'-6"	44	12	3'-6"	44	12	3'-6"	44	12	3'-6"	44	12	3'-6"	44	12	3'-6"	44
5d2	PIER & ABUT. DIAPH. LONGIT.		108	6'-2"	695	108	6'-2"	695	108	6'-2"	695	108	6'-2"	695	108	6'-2"	695	108	5'-11"	666	108	5'-11"	666	108	5'-11"	666	108	5'-11"	666
5d3	PIER & ABUT. DIAPH. LONGIT.		36	5'-3"	197	36	5'-3"	197	36	5'-3"	197	36	5'-3"	197	36	5'-3"	197	36	5'-0"	188	36	5'-0"	188	36	5'-0"	188	36	5'-0"	188
5d4	PIER DIAPH. LONGIT.		4	22'-10"	95	4	22'-10"	95	4	22'-10"	95	4	22'-10"	95	4	22'-10"	95	4	22'-10"	95	4	22'-10"	95	4	22'-10"	95	4	22'-10"	95
5d5	ABUT. DIAPH. ENDS		12	5'-0"	63	12	5'-0"	63	12	5'-0"	63	12	5'-0"	63	12	5'-0"	63	12	5'-0"	63	12	5'-0"	63	12	5'-0"	63	12	5'-0"	63
5d6	ABUT. DIAPH. LONGIT. B.F.		16	24'-6"	409	16	24'-6"	409	16	24'-6"	409	16	24'-6"	409	16	24'-6"	409	16	24'-6"	409	16	24'-6"	409	16	24'-6"	409	16	24'-6"	409
5d7	PAVING NOTCH LONGIT.		8	24'-2"	202	8	24'-2"	202	8	24'-2"	202	8	24'-2"	202	8	24'-2"	202	8	24'-2"	202	8	24'-2"	202	8	24'-2"	202	8	24'-2"	202
5d8	ABUT. DIAPH. WING EXT. LONGIT.																												
5d9	ABUT. DIAPH. WING EXT. LONGIT.																												
5e1	PIER DIAPH. HOOPS		48	8'-5"	421	48	8'-5"	421	48	9'-8"	484	48	9'-8"	484	48	9'-8"	484	48	10'-8"	534	48	10'-8"	534	48	10'-8"	534	48	10'-8"	534
5e2	PIER DIAPH. TIES ENDS		4	2'-7"	11	4	2'-7"	11	4	2'-7"	11	4	2'-7"	11	4	2'-7"	11	4	2'-7"	11	4	2'-7"	11	4	2'-7"	11	4	2'-7"	11
5e3	PIER DIAPH. TIES		48	2'-9"	138	48	2'-9"	138	48	2'-9"	138	48	2'-9"	138	48	2'-9"	138	48	2'-9"	138	48	2'-9"	138	48	2'-9"	138	48	2'-9"	138
5e4	PIER DIAPH. HOOPS ENDS		4	8'-3"	34	4	8'-3"	34	4	9'-6"	40	4	9'-6"	40	4	9'-6"	40	4	10'-6"	44	4	10'-6"	44	4	10'-6"	44	4	10'-6"	44
8f1	ABUT. FOOTING LONGIT.		36	25'-10"	2,483	36	25'-10"	2,483	36	25'-10"	2,483	36	25'-10"	2,483	36	25'-10"	2,483	36	25'-11"	2,491	36	25'-11"	2,491	36	25'-11"	2,491	36	25'-11"	2,491
8f3	ABUT. EXTENSION LONGIT.																												
8f4	ABUT. EXTENSION LONGIT.																												
8g1	ABUT. VERT.		158	6'-8"	2,812	158	6'-8"	2,812	158	7'-3"	3,058	158	7'-3"	3,058	158	7'-3"	3,058	154	7'-9"	3,187	154	7'-9"	3,187	154	7'-9"	3,187	154	7'-10"	3,221
8g3	ABUT. DIAPH. VERT. B.F.		74	15'-3"	3,013	74	15'-3"	3,013	74	15'-3"	3,013	74	15'-3"	3,013	74	15'-3"	3,013	74	15'-9"	3,112	74	15'-9"	3,112	74	15'-9"	3,112	74	15'-9"	3,112
6g4	ABUT. DIAPH. WING EXT. VERT.																												
5h1	ABUT. WING HORIZ. B.F.		28	6'-8"	195	28	6'-8"	195	28	6'-8"	195	28	6'-8"	195	28	6'-8"	195	36	6'-8"	250	36	6'-8"	250	36	6'-8"	250	36	6'-8"	250
5h2	ABUT. TO WING ANCHOR		56	4'-11"	287	56	4'-11"	287	56	4'-11"	287	56	4'-11"	287	56	4'-11"	287	12	4'-11"	62	12	4'-11"	62	12	4'-11"	62	12	4'-11"	62
5h3	ABUT. WING HORIZ. TRAFFIC FACE		28	6'-9"	197	28	6'-9"	197	28	6'-9"	197	28	6'-9"	197	28	6'-9"	197	36	6'-9"	253	36	6'-9"	253	36	6'-9"	253	36	6'-9"	253
5h4	ABUT. TO WING ANCHOR																												
5j1	TOP OF SLAB TRANSV. (AT RAIL)		338	6'-3"	2,203	368	6'-3"	2,399	398	6'-3"	2,594	428	6'-3"	2,790	458	6'-3"	2,986	488	6'-3"	3,181	518	6'-3"	3,377	548	6'-3"	3,572	588	6'-3"	3,833
5k1	PAVING NOTCH		78	4'-9"	386	78	4'-9"	386	78	4'-9"	386	78	4'-9"	386	78	4'-9"	386	78	4'-9"	386	78	4'-9"	386	78	4'-9"	386	78	4'-9"	386
5k2	PAVING NOTCH		78	3'-5"	278	78	3'-5"	278	78	3'-5"	278	78	3'-5"	278	78	3'-5"	278	78	3'-5"	278	78	3'-5"	278	78	3'-5"	278	78	3'-5"	278
5p1	ABUTMENT HOOPS (WOOD/STEEL)		120/152	10'-6"	1314/1665	120/152	10'-6"	1314/1665	136/152	10'-6"	1489/1665	136/148	10'-6"	1489/1621	144/148	10'-6"	1577/1621	156	10'-6"	1,708	144	10'-6"	1,577	144	10'-6"	1,577	144	10'-6"	1,577
5p2	ABUTMENT HOOPS																												
6p3	ABUT. BOT. AT PILES																												
5e1	PIER DIAPH. HOOPS																												
5e4	PIER DIAPH. HOOPS ENDS																												
5p1 & 5p2	ABUTMENT HOOPS																												
4+1	UNDER BEAMS AT ABUTMENTS		14	4'-6"	42	14	4'-6"	42	14	4'-6"	42	14	4'-6"	42	14	4'-6"	42	14	4'-9"	44	14	4'-9"	44	14	4'-9"	44	14	4'-9"	44
#2	PILE SPIRAL (WOOD/STEEL)*		30/14	38'-6"	193/90	30/14	38'-6"	193/90	34/14	38'-6"	219/90	34/16	38'-6"	219/103	36/16	38'-6"	231/103	20	38'-6"	129	22	38'-6"	141	22	38'-6"	141	22	38'-6"	141
	SPIRAL SPACERS, L ₁ & L ₂ @ 0.70 (WOOD/STL.)*		90/42	1'-10"	116/54	90/42	1'-10"	116/54	102/42	1'-10"	131/54	102/48	1'-10"	131/62	108/48	1'-10"	139/62	60	1'-10"	77	66	1'-10"	85	66	1'-10"	85	66	1'-10"	85
	*EPOXY COATING NOT REQUIRED																												
	SUB TOTAL W/ WOOD PILES**				58,261			62,096			66,704			71,381			75,411												
	SUB TOTAL W/ STEEL H-PILES**				58,447			62,282			66,674			71,328			75,250												
	**RAIL REINFORCING NOT INCLUDED																												

NOTE: REINFORCING STEEL QUANTITIES ARE TO BE INCLUDED ON THE SUMMARY QUANTITIES SHEET IN THE PLAN.

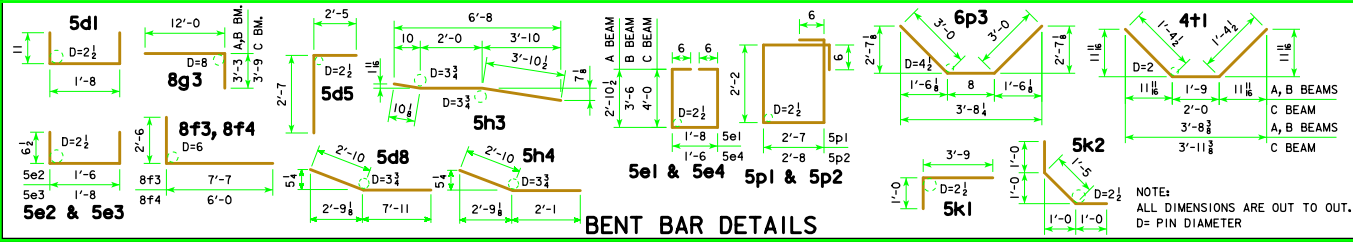

IOWADOT Highway Division

STANDARD DESIGN - 44' ROADWAY, THREE SPAN BRIDGE

PRETENSIONED PRESTRESSED CONCRETE BEAM BRIDGES

SEPTEMBER, 2014

LATEST REVISION DATE

APPROVED BY