

REVISED 05-11 - CORRECTED THE OPEN RAIL REBAR QUANTITIES FOR THE 20'-4, 23'-1, 26'-4, & 243'-0 BRIDGE LENGTHS.

REINFORCING BAR LIST
ONE SUPERSTRUCTURE AND TWO ABUTMENTS

BAR	LOCATION	SHAPE	138'-10			151'-4			163'-10			176'-4			188'-10			201'-4			213'-10			226'-4			243'-0		
			NO.	LENGTH	WEIGHT	NO.	LENGTH	WEIGHT	NO.	LENGTH	WEIGHT	NO.	LENGTH	WEIGHT	NO.	LENGTH	WEIGHT	NO.	LENGTH	WEIGHT	NO.	LENGTH	WEIGHT	NO.	LENGTH	WEIGHT	NO.	LENGTH	WEIGHT
601	SLAB TRANSV. TOP & BOTT.		321	32'-10	15,830	351	32'-10	17,310	381	32'-10	18,789	411	32'-10	20,269	441	32'-10	21,748	471	32'-10	23,228	501	32'-10	24,707	531	32'-10	26,187	571	32'-10	28,159
602	SLAB TRANSV. TOP ENDS		20	VARIES	484	20	VARIES	484	20	VARIES	484	20	VARIES	484	20	VARIES	484	20	VARIES	484	20	VARIES	484	20	VARIES	484	20	VARIES	484
603	SLAB TRANSV. BOTT. ENDS		18	VARIES	436	18	VARIES	436	18	VARIES	436	18	VARIES	436	18	VARIES	436	18	VARIES	436	18	VARIES	436	18	VARIES	436	18	VARIES	436

EPOXY COATED REINFORCING

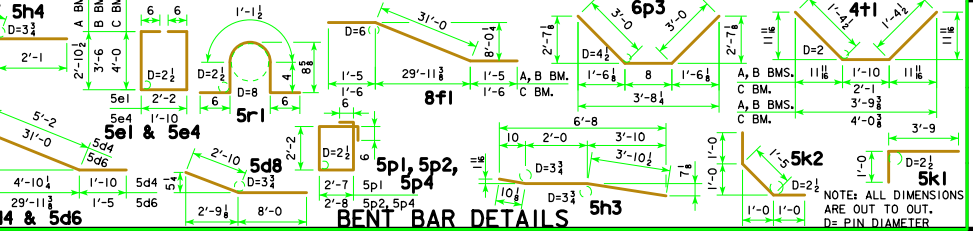

05-11
LATEST REVISION DATE
Norman E. M. Russell
APPROVED BY BRIDGE ENGINEER



STANDARD DESIGN - 30' ROADWAY, THREE SPAN BRIDGES
PRETENSIONED PRESTRESSED CONCRETE BEAM BRIDGES
DECEMBER, 2006

DECK & ABUTMENT REINF. 15° SKEW
H30-16-06

NOTE: ALL DIMENSIONS ARE OUT TO OUT. DE-PIN DIAMETER.