

- ① Modify dimensions as required to accommodate other curb heights when specified.
- ② Insert shaping may be modified for insert widths less than 36 inches. For an 18 inch insert, reduce dimensions indicated by 1/4 inch.
- ③ 12 inch minimum wall height above all pipes.
- ④ Slope of 1.5% or as specified in the contract documents.

		REVISION
		4 10-21-14
FIGURE 6010.510	STANDARD ROAD PLAN	SW-510
		SHEET 1 of 2

REVISIONS: Added circle note 4.

Paul D. Wigand
SUDAS DIRECTOR

Brian Smith
DESIGN METHODS ENGINEER

DOUBLE OPEN-THROAT CURB INTAKE, LARGE BOX

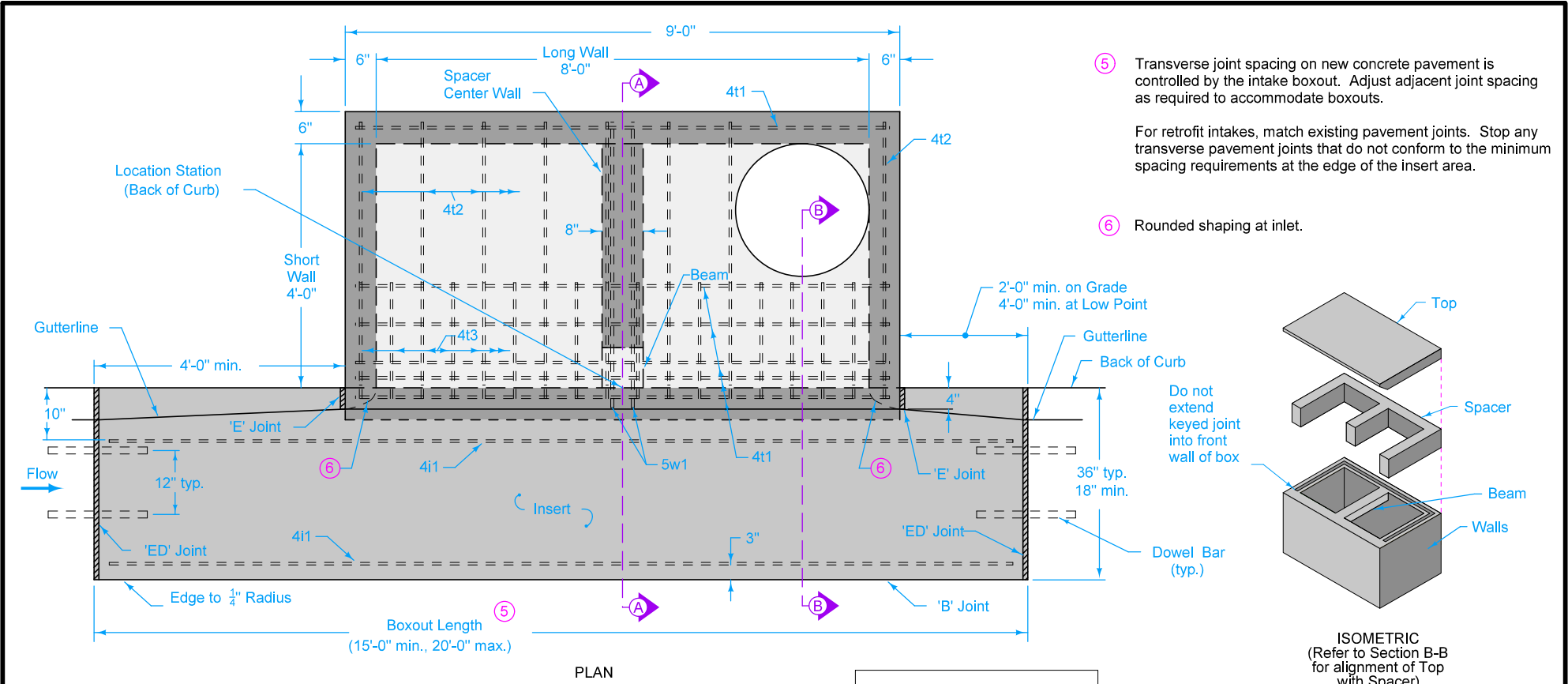

PLAN

REINFORCING BAR LIST						
Mark	Size	Location	Shape	Count	Length	Spacing
4b1	4	Base	—	9	4'-6"	12"
4b2	4	Base	—	6	8'-6"	11"
4i1	4	Insert	—	4	Boxout Length minus 8"	See Insert
4t1	4	Top	—	7	8'-6"	See Plan
4t2	4	Top	—	8	4'-4"	12"
4t3	4	Top	—	18	1'-10"	6"
4w1	4	Walls	—	24	Wall Height minus 4"	13"
4w2	4	Long Walls	—	Varies	4'-8"	12"
4w3	4	Short Walls	—	Varies	8'-8"	12"
5w1	5	Beam	┌	2	8'-3"	4"

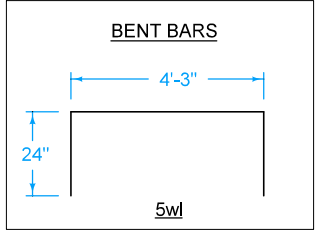

MAXIMUM PIPE DIAMETERS		
Pipe Location	Precast Structure	Cast-in-place Structure
Short Wall	30"	36"
Long Wall	60"	66"

SUDAS IOWADOT	REVISION 4 10-21-14
	FIGURE 6010.510 STANDARD ROAD PLAN SW-510 SHEET 2 of 2

REVISIONS: Added circle note 4.

Paul D. Wigand
 SUDAS DIRECTOR

Brian Smith
 DESIGN METHODS ENGINEER

DOUBLE OPEN-THROAT CURB INTAKE, LARGE BOX