

45° SKEWED FRAMING PLAN  
(R.A. SHOWN, L.A. SIMILAR)

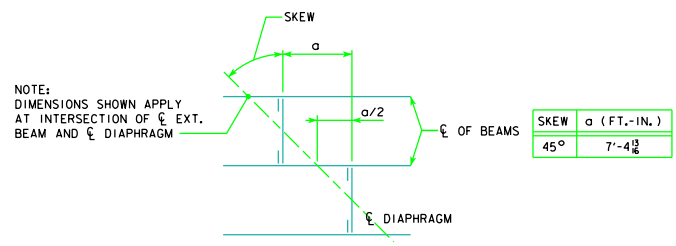

LATEST REVISION DATE  <i>Mark E. McDonald</i> APPROVED BY BRIDGE ENGINEER		
	STANDARD DESIGN - 40' ROADWAY, 3 SPAN BRIDGES <b>ROLLED STEEL BEAM BRIDGES</b> JUNE, 2010	
	FRAMING PLAN 340'-0 BRIDGE	RS40-060-10