

		CAP																														
REINFORCING STEEL		160'-0			180'-0			200'-0			220'-0			240'-0			260'-0			280'-0			300'-0			320'-0			340'-0			
BAR	LENGTH	SHAPE	NO.	SIZE	WEIGHT	NO.	SIZE	WEIGHT	NO.	SIZE	WEIGHT	NO.	SIZE	WEIGHT	NO.	SIZE	WEIGHT	NO.	SIZE	WEIGHT	NO.	SIZE	WEIGHT	NO.	SIZE	WEIGHT	NO.	SIZE	WEIGHT			
q1	43'-8		6	9	891	6	9	891	6	9	891	6	10	1127	6	10	1127	6	10	1127	6	11	1392	6	11	1392	6	11	1392	6	11	1392
q2	43'-8		6	8	700	6	8	700	6	9	891	6	9	891	6	10	1127	6	10	1127	6	10	1127	6	11	1392	6	11	1392	6	11	1392
q3	43'-8		--	--	--	--	--	--	--	--	--	--	--	--	--	--	--	--	--	--	--	--	--	--	--	--	--	--	--	--	--	
6o4	43'-8		6	6	394	6	6	394	6	6	394	6	6	394	6	6	394	6	6	394	6	6	394	6	6	394	6	6	394	6	6	394
6o5	41'-8		2	6	125	2	6	125	2	6	125	2	6	125	2	6	125	2	6	125	2	6	125	2	6	125	2	6	125	2	6	125
6o6	35'-4		2	6	106	2	6	106	2	6	106	2	6	106	2	6	106	2	6	106	2	6	106	2	6	106	2	6	106	2	6	106
6o7	29'-0		2	6	87	2	6	87	2	6	87	2	6	87	2	6	87	2	6	87	2	6	87	2	6	87	2	6	87	2	6	87
8b1	23'-4		8	8	498	8	8	498	8	8	498	8	8	498	8	8	498	8	8	498	8	8	498	8	8	498	8	8	498	8	8	498
5c1	17'-5		26	5	472	26	5	472	26	5	472	26	5	472	26	5	472	26	5	472	26	5	472	26	5	472	26	5	472	26	5	472
5c2	VARIES		12	5	213	12	5	213	12	5	213	12	5	213	12	5	213	12	5	213	12	5	213	12	5	213	12	5	213	12	5	213
5c3	VARIES		40	5	570	40	5	570	40	5	570	40	5	570	40	5	570	40	5	570	40	5	570	40	5	570	40	5	570	40	5	570
5c4	6'-11		20	5	144	20	5	144	20	5	144	20	5	144	20	5	144	20	5	144	20	5	144	20	5	144	20	5	144	20	5	144
TOTAL (LB.)			4200			4200			4391			4627			4863			5034			5370			5806			5937			6103		
STRUCTURAL CONCRETE (CY)			29.9			29.9			29.9			29.9			29.9			29.9			29.9			29.9			29.9					

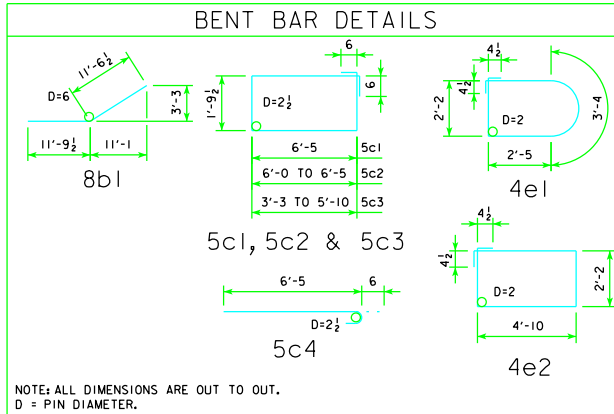

		COLUMN													
REINFORCING STEEL		REINFORCING STEEL													
H IN FEET	COLUMN HEIGHT	STRUCTURAL CONCRETE (CY)	d1 BAR				4e1 BAR				4e2 BAR				TOTAL WEIGHT (LB.)
			NO.	SIZE	LENGTH	WEIGHT	NO.	SIZE	LENGTH	WEIGHT	NO.	SIZE	LENGTH	WEIGHT	
16	5'-3	9.9	58	9	8'-0	1578	12	4	11'-1	89	30	4	14'-9	296	1963
17	6'-3	11.8	58	9	9'-0	1775	14	4	11'-1	104	35	4	14'-9	345	2224
18	7'-3	13.7	58	9	10'-0	1972	16	4	11'-1	118	40	4	14'-9	394	2484
19	8'-3	15.6	58	9	11'-0	2169	18	4	11'-1	133	45	4	14'-9	443	2745
20	9'-3	17.5	58	9	12'-0	2366	20	4	11'-1	148	50	4	14'-9	493	3007
21	10'-3	19.4	58	9	13'-0	2564	22	4	11'-1	163	55	4	14'-9	542	3269
22	11'-3	21.3	58	9	14'-0	2761	24	4	11'-1	178	60	4	14'-9	591	3530
23	12'-3	23.2	58	9	15'-0	2958	26	4	11'-1	192	65	4	14'-9	640	3790
24	13'-3	25.1	58	9	16'-0	3155	28	4	11'-1	207	70	4	14'-9	690	4052
25	14'-3	27.0	58	9	17'-0	3352	30	4	11'-1	222	75	4	14'-9	739	4313
26	15'-3	28.9	58	9	18'-0	3550	32	4	11'-1	237	80	4	14'-9	788	4575
27	16'-3	30.8	58	9	19'-0	3747	34	4	11'-1	252	85	4	14'-9	838	4837
28	17'-3	32.7	58	9	20'-0	3944	36	4	11'-1	267	90	4	14'-9	887	5098
29	18'-3	34.6	58	9	21'-0	4141	38	4	11'-1	281	95	4	14'-9	936	5358
30	19'-3	36.5	58	9	22'-0	4338	40	4	11'-1	296	100	4	14'-9	985	5619
31	20'-3	38.4	58	9	23'-0	4536	42	4	11'-1	311	105	4	14'-9	1035	5882
32	21'-3	40.3	58	9	24'-0	4733	44	4	11'-1	326	110	4	14'-9	1084	6143
33	22'-3	42.2	58	9	25'-0	4930	46	4	11'-1	341	115	4	14'-9	1133	6404
34	23'-3	44.1	58	9	26'-0	5127	48	4	11'-1	355	120	4	14'-9	1182	6664
35	24'-3	45.9	58	9	27'-0	5324	50	4	11'-1	370	125	4	14'-9	1232	6926
36	25'-3	47.8	58	9	28'-0	5522	52	4	11'-1	385	130	4	14'-9	1281	7188
37	26'-3	49.7	58	9	29'-0	5719	54	4	11'-1	400	135	4	14'-9	1330	7449
38	27'-3	51.6	58	9	30'-0	5916	56	4	11'-1	415	140	4	14'-9	1379	7710
39	28'-3	53.5	58	9	31'-0	6113	58	4	11'-1	429	145	4	14'-9	1429	7971
40	29'-3	55.4	58	9	32'-0	6310	60	4	11'-1	444	150	4	14'-9	1478	8232

PIER NOTES:

SEE "TEE PIER NOTES" ON RS40-003-10 FOR NOTES REGARDING APPLICATION OF THESE PIER STANDARDS.

MINIMUM CLEAR DISTANCE FROM FACE OF CONCRETE TO NEAR REINFORCING BAR SHALL BE 2 INCHES UNLESS OTHERWISE NOTED OR SHOWN.

① SEE SHEET RS40-167-10 FOR STEP REINFORCING STEEL QUANTITIES AND DETAILS.

LATEST REVISION DATE <i>Thomas L. Mc Donald</i> APPROVED BY BRIDGE ENGINEER		
	STANDARD DESIGN - 40' ROADWAY, 3 SPAN BRIDGES ROLLED STEEL BEAM BRIDGES JUNE, 2010	
	TEE PIER CAP & COLUMN DETAILS 20° SKEW	RS40-137-10