

CAP

REINFORCING STEEL	CAP ABUT. BEARINGS	160'-0"		180'-0"		200'-0"		220'-0"		240'-0"		260'-0"		280'-0"		300'-0"		320'-0"		340'-0"			
		NO.	SIZE	WEIGHT	NO.	SIZE	WEIGHT	NO.	SIZE	WEIGHT	NO.	SIZE	WEIGHT	NO.	SIZE	WEIGHT	NO.	SIZE	WEIGHT	NO.	SIZE	WEIGHT	
Q1	41'-8"	6	9	850	6	9	850	6	9	850	6	10	1076	6	10	1076	6	11	1328	6	11	1328	
Q2	41'-8"	6	8	668	6	8	668	6	9	850	6	9	850	6	10	1076	6	10	1076	6	11	1328	
Q3	41'-8"	1	1	1	1	1	1	1	1	1	1	1	1	1	1	1	1	1	1	1	1	1	
604	41'-8"	6	6	376	6	6	376	6	6	376	6	6	376	6	6	376	6	6	376	6	6	376	
605	39'-7"	2	6	119	2	6	119	2	6	119	2	6	119	2	6	119	2	6	119	2	6	119	
606	34'-3"	2	6	103	2	6	103	2	6	103	2	6	103	2	6	103	2	6	103	2	6	103	
607	27'-8"	2	6	83	2	6	83	2	6	83	2	6	83	2	6	83	2	6	83	2	6	83	
8b1	22'-4"	8	8	477	8	8	477	8	8	477	8	8	477	8	8	477	8	8	477	8	8	477	
5c1	16'-10"	26	5	456	26	5	456	26	5	456	26	5	456	26	5	456	26	5	456	26	5	456	
5c2	VARIABLES	8	5	138	8	5	138	8	5	138	12	5	207	12	5	207	12	5	207	12	5	207	
5c3	VARIABLES	40	5	563	40	5	563	40	5	563	40	5	563	52	5	732	52	5	732	68	5	957	
5c4	6'-8"	20	5	139	20	5	139	20	5	139	20	5	139	20	5	139	20	5	139	20	5	139	
TOTAL (LB.)				3972		3972		4154		4449		4675		4844		5096		5573		5698		5856	
STRUCTURAL CONCRETE (CY)				27.7		27.7		27.7		27.7		27.7		27.7		27.7		27.7		27.7		27.7	

COLUMN

H IN FEET	COLUMN HEIGHT	STRUCTURAL CONCRETE (CY)	REINFORCING STEEL												TOTAL WEIGHT (LB.)								
			d1 BAR		4e1 BAR		4e2 BAR		4e3 BAR		4e4 BAR		4e5 BAR										
				NO.	SIZE	LENGTH	WEIGHT	NO.	SIZE	LENGTH	WEIGHT	NO.	SIZE	LENGTH	WEIGHT	NO.	SIZE	LENGTH	WEIGHT	NO.	SIZE	LENGTH	WEIGHT
16	5'-6"	9.9	54	9	8'-3"	1515	12	4	9'-9"	78	12	4	13'-5"	108	18	4	15'-1"	181	1882				
17	6'-6"	11.7	54	9	9'-3"	1698	14	4	9'-9"	91	14	4	13'-5"	125	21	4	15'-1"	212	2126				
18	7'-6"	13.5	54	9	10'-3"	1882	16	4	9'-9"	104	16	4	13'-5"	143	24	4	15'-1"	242	2371				
19	8'-6"	15.3	54	9	11'-3"	2066	18	4	9'-9"	117	18	4	13'-5"	161	27	4	15'-1"	272	2616				
20	9'-6"	17.1	54	9	12'-3"	2249	20	4	9'-9"	130	20	4	13'-5"	179	30	4	15'-1"	302	2860				
21	10'-6"	18.9	54	9	13'-3"	2433	22	4	9'-9"	143	22	4	13'-5"	197	33	4	15'-1"	332	3105				
22	11'-6"	20.7	54	9	14'-3"	2616	24	4	9'-9"	156	24	4	13'-5"	215	36	4	15'-1"	363	3350				
23	12'-6"	22.5	54	9	15'-3"	2800	26	4	9'-9"	169	26	4	13'-5"	233	39	4	15'-1"	393	3595				
24	13'-6"	24.3	54	9	16'-3"	2984	28	4	9'-9"	182	28	4	13'-5"	251	42	4	15'-1"	423	3840				
25	14'-6"	26.1	54	9	17'-3"	3167	30	4	9'-9"	195	30	4	13'-5"	269	45	4	15'-1"	453	4084				
26	15'-6"	27.9	54	9	18'-3"	3351	32	4	9'-9"	208	32	4	13'-5"	287	48	4	15'-1"	484	4330				
27	16'-6"	29.7	54	9	19'-3"	3534	34	4	9'-9"	221	34	4	13'-5"	305	51	4	15'-1"	514	4574				
28	17'-6"	31.5	54	9	20'-3"	3718	36	4	9'-9"	234	36	4	13'-5"	323	54	4	15'-1"	544	4819				
29	18'-6"	33.3	54	9	21'-3"	3902	38	4	9'-9"	247	38	4	13'-5"	341	57	4	15'-1"	574	5064				
30	19'-6"	35.1	54	9	22'-3"	4085	40	4	9'-9"	261	40	4	13'-5"	358	60	4	15'-1"	605	5309				
31	20'-6"	36.9	54	9	23'-3"	4269	42	4	9'-9"	274	42	4	13'-5"	376	63	4	15'-1"	635	5554				
32	21'-6"	38.7	54	9	24'-3"	4452	44	4	9'-9"	287	44	4	13'-5"	394	66	4	15'-1"	665	5798				
33	22'-6"	40.5	54	9	25'-3"	4636	46	4	9'-9"	300	46	4	13'-5"	412	69	4	15'-1"	695	6043				
34	23'-6"	42.4	54	9	26'-3"	4820	48	4	9'-9"	313	48	4	13'-5"	430	72	4	15'-1"	725	6288				
35	24'-6"	44.2	54	9	27'-3"	5003	50	4	9'-9"	326	50	4	13'-5"	448	75	4	15'-1"	756	6533				
36	25'-6"	46.0	54	9	28'-3"	5187	52	4	9'-9"	339	52	4	13'-5"	466	78	4	15'-1"	786	6778				
37	26'-6"	47.8	54	9	29'-3"	5370	54	4	9'-9"	352	54	4	13'-5"	484	81	4	15'-1"	816	7022				
38	27'-6"	49.6	54	9	30'-3"	5554	56	4	9'-9"	365	56	4	13'-5"	502	84	4	15'-1"	846	7267				
39	28'-6"	51.4	54	9	31'-3"	5738	58	4	9'-9"	378	58	4	13'-5"	520	87	4	15'-1"	877	7513				
40	29'-6"	53.2	54	9	32'-3"	5921	60	4	9'-9"	391	60	4	13'-5"	538	90	4	15'-1"	907	7757				

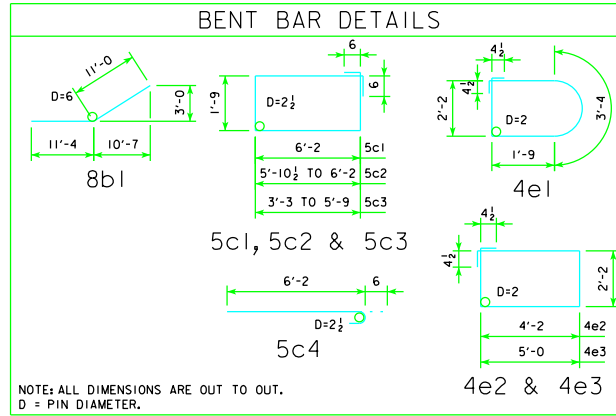

NOTE: ALL DIMENSIONS ARE OUT TO OUT.  
D = PIN DIAMETER.

PIER NOTES:

SEE "TEE PIER NOTES" ON RS40-003-10 FOR NOTES REGARDING APPLICATION OF THESE PIER STANDARDS.

MINIMUM CLEAR DISTANCE FROM FACE OF CONCRETE TO NEAR REINFORCING BAR SHALL BE 2 INCHES UNLESS OTHERWISE NOTED OR SHOWN.

SEE SHEET RS40-166-10 FOR STEP REINFORCING STEEL QUANTITIES AND DETAILS.

LATEST REVISION DATE	<i>Thomas L. Mc Donald</i> APPROVED BY BRIDGE ENGINEER		STANDARD DESIGN - 40' ROADWAY, 3 SPAN BRIDGES	
			ROLLED STEEL BEAM BRIDGES	
		JUNE, 2010		
		TEE PIER CAP & COLUMN DETAILS 10° SKEW		RS40-127-10